

Fender Eliminator Kit

Part no: FE-Y15R3 2015-2018 Yamaha YZF R3

Part no: FE-Y19R3 2019+ Yamaha YZF R3

Parts List

- x1 Under tail block off plate
- x1 License plate holder
- x1 License plate LED light
- x1 License plate light adapter harness
- x4 6x12mm allen bolts
- x4 6x16mm allen bolts
- x8 6mm washers
- x8 6mm nylon lock nuts
- x2 OEM signal adapters
- x2 Aftermarket 10mm signal adapters

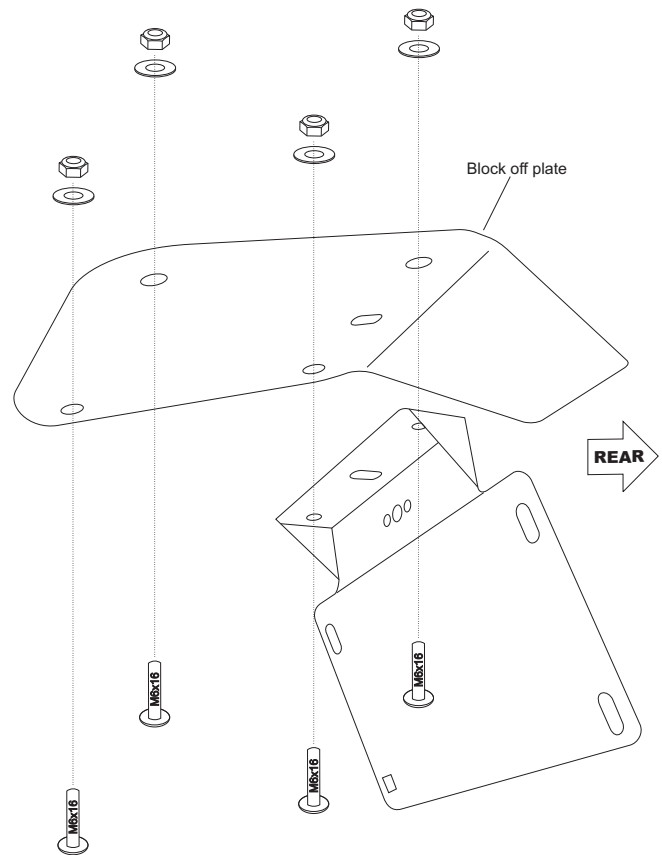

1. Remove rear seat. Remove storage tray (2 rivets). Remove center upper cover (2 bolts). Remove main seat (2 bolts). Unbolt the factory rear fender (6 bolts and 4 screws to drop the lower half and 4 nuts on top for the upper half). You no longer need these nuts

2. Unplug left and right turn signal connectors as well as license plate light connector (Turn signals connectors wrapped in clear rubber close to battery)

3. Pull out the fender along with the turn signal and license plate light wires.

4. Mount license plate holder and block off plate to the bike using the four M6x16mm bolts, washers and nuts from this kit. See illustration to right

5. Attach the LED license plate light to plate holder. Feed wires through hole on plate holder. Attach adapter harness to LED plate light (White>White wire and Black>Black wire) and plug it back into bike removed from step 2.

6. Mount license plate to plate holder using four 6x12mm bolts, washers, and lock nuts from this kit.

7. Optional: Mount OEM or aftermarket turn signal adapters to license plate mounting holes on plate holder using two/four 6x12mm allen bolts, washers, and nuts. Install OEM or aftermarket turn signals onto adapter and route wires through rear hole of the fender hole block plate and plug into appropriate plug removed from step 2. Aftermarket signals may require wiring. Refer to illustration on right to mount factory signals.

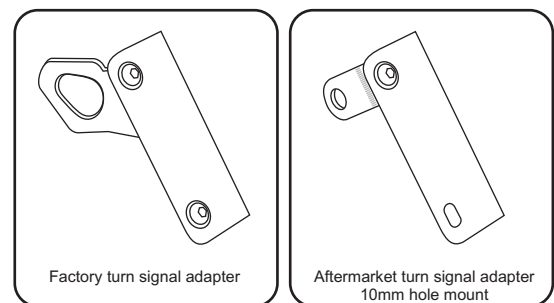

8. Check all lighting